



**READY TO MOVE-IN
PREMIUM OFFICES**



D.N. Nagar, Andheri (W)

www.lotuslinksquare.com



The centre of Mumbai, the centre of Corporate India is your runway.

Premium office spaces to stay connected to every part of Mumbai. The offices are designed in direct response to the needs of contemporary businesses and their employees. The well-serviced building is secure, high-tech, and eco-friendly with incredible amenities.

*Artistic Impression

- ✦ Located at D.N. Nagar metro station
- ✦ Premium office spaces from 545 - 10000 sqft
- ✦ State-of-the-art fire fighting equipment
- ✦ 100% commercial approved project
- ✦ Modern 18 storey elevation
- ✦ Efficient workspaces
- ✦ Vaastu complaint
- ✦ 24*7 Security
- ✦ Earthquake Resistant Structure
- ✦ Automated parking system
- ✦ 3 passenger elevators

Typical Floor Plan (Commercial Wing)



J.P. Road (Metro View)

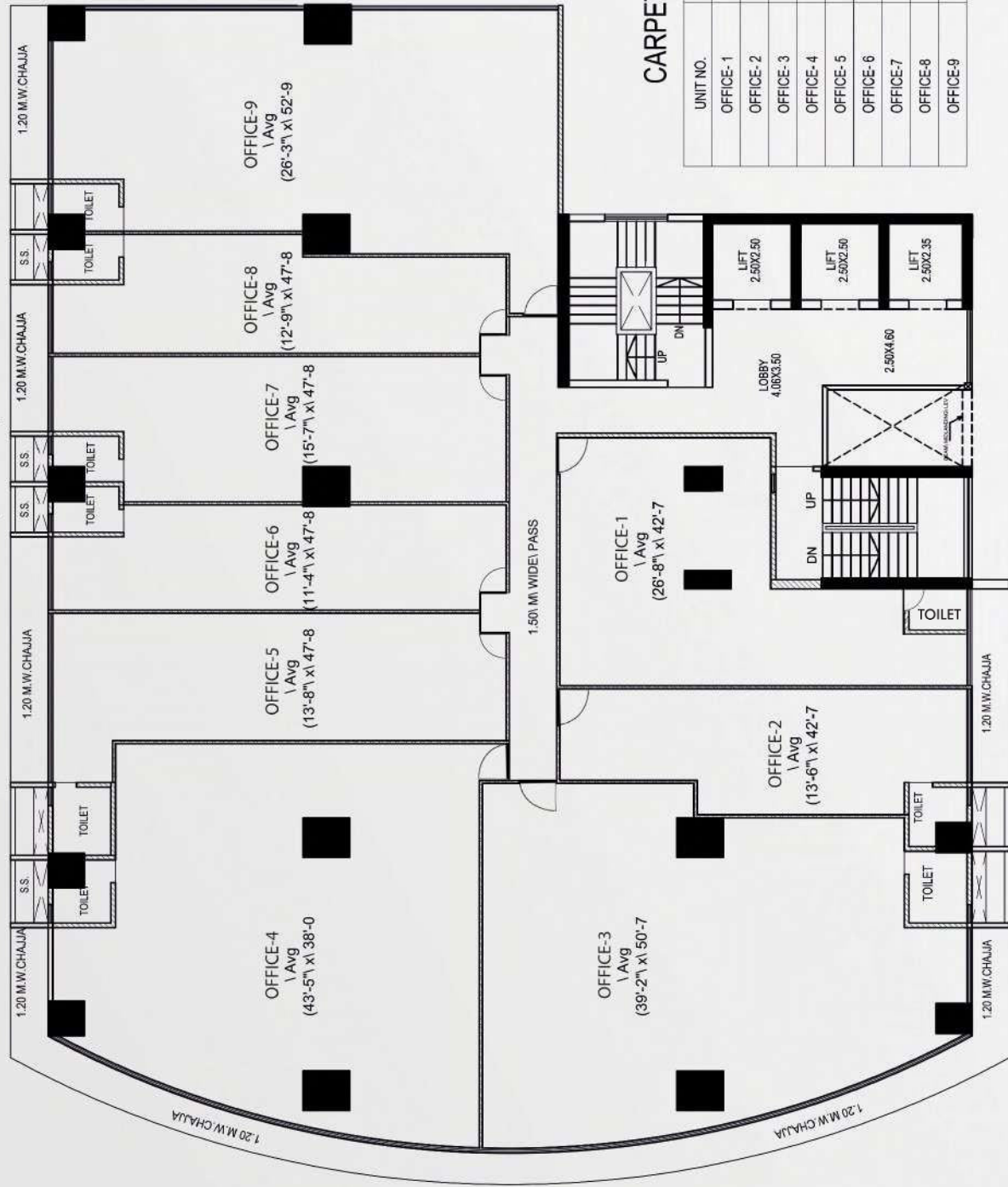

CARPET AREA

UNIT NO.	CARPET AREA
OFFICE-1	802 SQ.FT.
OFFICE-2	545 SQ.FT.
OFFICE-3	1666 SQ.FT.
OFFICE-4	1675 SQ.FT.
OFFICE-5	725 SQ.FT.
OFFICE-6	550 SQ.FT.
OFFICE-7	725 SQ.FT.
OFFICE-8	554 SQ.FT.
OFFICE-9	1352 SQ.FT.

Link Road

This Floor Plan is purely conceptual and not a legal offering. All the designs and dimensions are subject to the approval of the respective authorities. The developers reserves right to change the specifications or features without any notice or any obligation.



D.N. Nagar, Andheri (W)

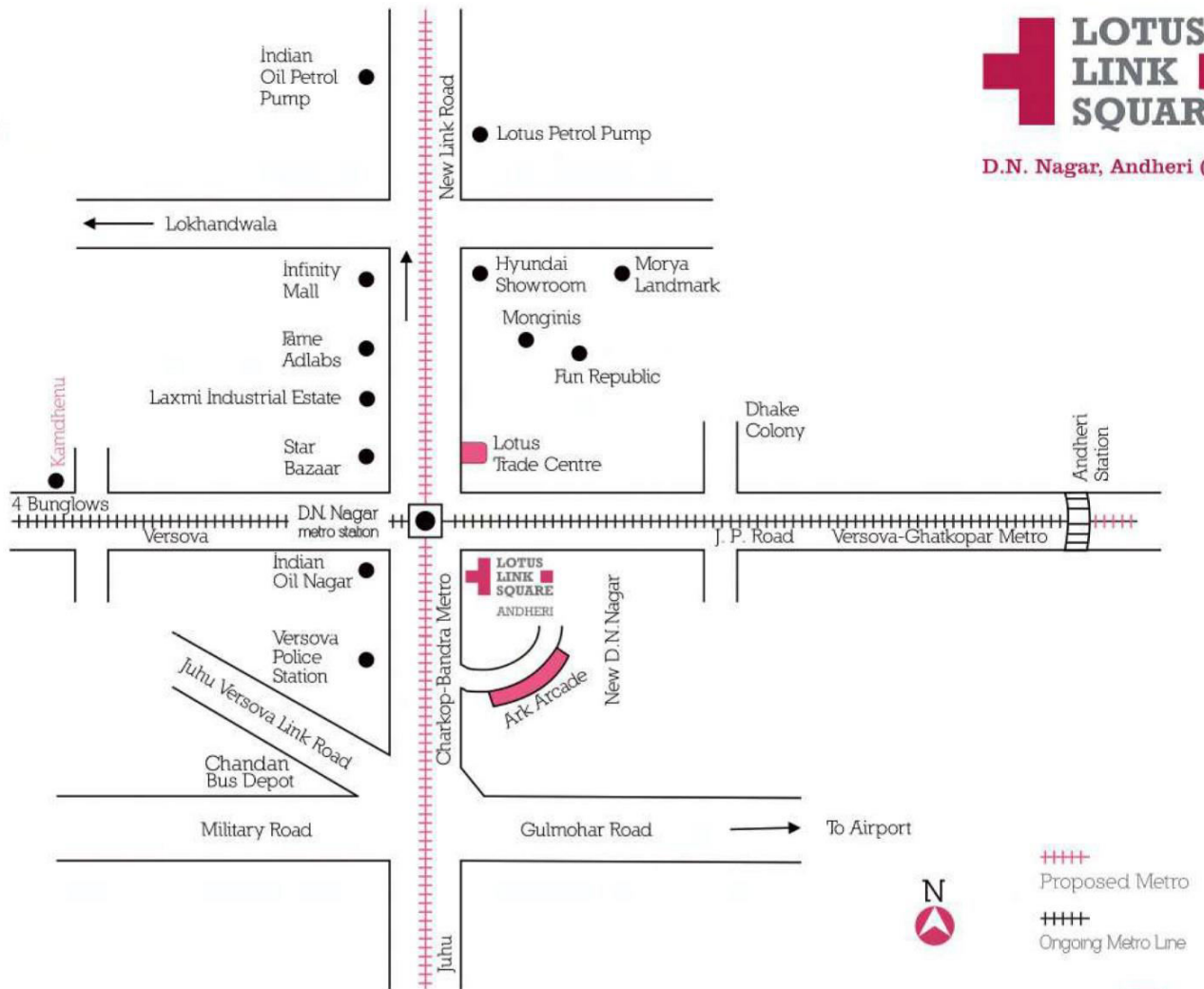

☎ **9821 563 564**

Site & Sales Office:

Lotus Link Square, Opp. D.N. Nagar Metro Station, Andheri (W), Mumbai – 400053

Corporate Office:

1301, Lotus Trade Centre, New Link Road, Andheri (W), Mumbai – 400053

www.lotusgroup.in



The project has been registered via MahaRERA registration number: **P51800005163** & available on the website <https://maharera.mahaonline.gov.in> under registered projects. *OC Received Till 16th Floor

The information contain herewith does not constitute an offer and/or contract of any type between the developer/owner and the recipient. All sales/leases shall be governed by the terms of the agreement for sale/lease. Travel time is approximate and can vary according to traffic & weather situations. Published on November 2019